

Kurz- und Lang-Ausführung

Muffen

Abb. 1

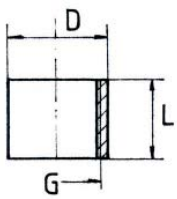

Type **MK**
Schweißmuffe
kurz

Abb. 2

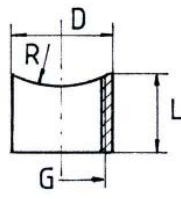

Type **MKR**
Schweißmuffe
mit Radius
(R = 10-12,5-16-
20-25-31 mm)

Abb. 3

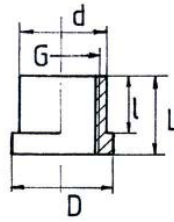

Type **MKd**
Sondermuffe
auf Anfrage

Abb. 4

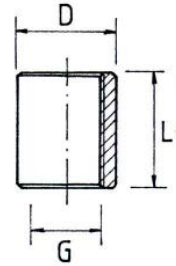

Type **ML**
Schweißmuffe
lang

Abb. 5

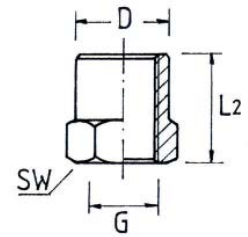

Type **MS**
Schraubmuffe

Abb. 6

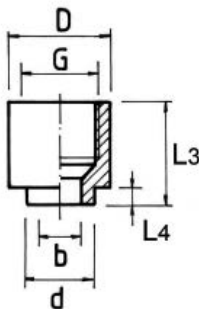

Type **MKE**
Schweißmuffe
zum Einstecken
auf Anfrage

| Gewinde-anschluss | Muffen-Abmessungen (mm) | | | | |
|-------------------|-------------------------|----|----|----|----|
| | L | D | L1 | L2 | SW |
| 1/16" | 10 | 10 | | | |
| 1/8" | 11 | 14 | | 10 | 14 |
| 1/4" | 12 | 17 | 24 | 10 | 17 |
| 3/8" | 15 | 20 | 26 | 10 | 22 |
| 1/2" | 18 | 25 | 30 | 15 | 27 |
| 3/4" | 22 | 32 | 35 | 20 | 32 |
| 1" | 25 | 36 | 40 | 40 | 36 |

Werkstoffe: Messing und Edelstahl

Verlängerungs-Adapter

Abb. 7

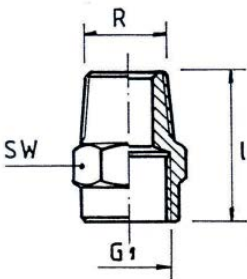

N
mit konischem
Außengewinde

Abb. 8

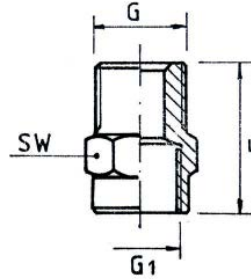

NG
mit zylindrischem
Außengewinde

Abb. 9

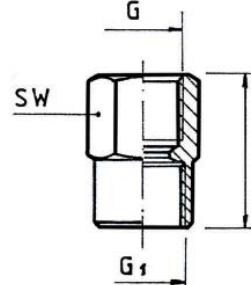

NI
mit Innengewinde

| Gew. G+R | G1 | L | SW |
|----------|------|----|----|
| 1/8" | 1/8" | 18 | 12 |
| 1/4" | 1/4" | 22 | 17 |
| 3/8" | 3/8" | 24 | 22 |
| 1/2" | 1/2" | 32 | 24 |

Abb. 10

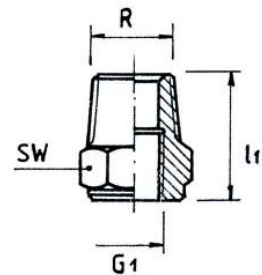

R 1
mit Außen- und Innengewinde

Reduzierungen

Abb. 11

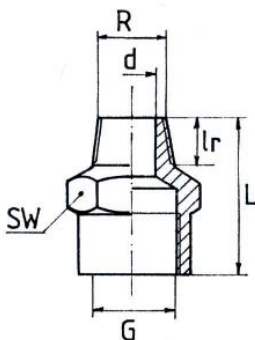

R 2
mit Außen- und Innengewinde

| Type R1 Gew. R | L1 | G1 | SW |
|-------------------|----|---------------------|----|
| 1/4" | 18 | 1/8" | 14 |
| 3/8" | 19 | 1/8"-1/4" | 17 |
| 1/2" | 27 | 1/8"-1/4"-3/8" | 22 |
| 3/4" | 32 | 1/8"-1/4"-3/8"-1/2" | 27 |

| Type R2 Gew. R | Lr | d | G | | | L | | | SW | | |
|-------------------|----|------|------|------|------|----|----|----|----|----|----|
| | | | A | B | C | A | B | C | A | B | C |
| 1/8" | 7 | Ø 4 | 1/8" | 1/4" | 3/8" | 20 | 24 | 25 | 14 | 17 | 22 |
| 1/4" | 10 | Ø 7 | 1/4" | 3/8" | 1/2" | 27 | 28 | 32 | 17 | 22 | 27 |
| 3/8" | 11 | Ø 10 | 3/8" | 1/2" | 3/4" | 28 | 32 | 36 | 22 | 27 | 32 |
| 1/2" | 13 | Ø 14 | 1/2" | 3/4" | 1" | 35 | 38 | 42 | 27 | 32 | 41 |

andere Varianten auf Anfrage

Bestellbeispiel: (Type - Außengewinde - Innengewinde - Werkstoff)
R 2 - 1/4" - 3/8" - VA