

Characteristics

Bundle nozzles create a full cone spray pattern with the help of several merging hollow cones. The result are micro-droplets.

Application

Suppression
Washing
Cleaning
Cooling of parts
Air or gas
Fire protection

Material

Brass
Stainless steel
PVC*

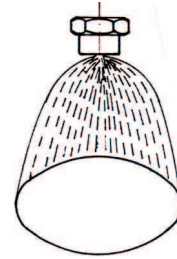

Full cone spray pattern

Type	Thread	Spray angle	SW1	SW2	H	D	
B	1/2"	70°	46	38	25	50	
	1/2"	130°	27	36	28	40	
	1/2"	130°	27	35	32	45	PVC*
B	3/4"	70°	65	55	46	75	
	3/4"	130°	46	55	46	62	
	3/4"	130°	46	55	46	70	PVC*
B	1"	70°	105	120	75	138	
	1"	130°	90	110	82	120	
	2"	70°	130	165	108	185	
	2"	130°	120	140	102	155	

Illu. 1

70°

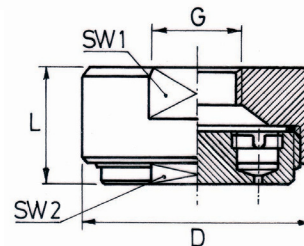

Type B-70°

Order example: (thread - type - spray angle - material) 3/4" - 7,10 - 70° - V2A

B = outlet bore, E = smallest section, bores vary slightly for different spray angles

Spray angle		Type B	Thread	Bore (mm)		Flow rate V (l/min.) at pressure p (bar)					
70°	130°			B	E	0.5	1	2	3	5	10
*	*	1.25	1/2"	1.00	0.50	-	-	1.25	1.53	1.98	2.80
*	*	2.24	"	1.80	0.50	-	1.58	2.24	2.74	3.54	5.01
*	*	2.80	3/4"	1.00	1.00	1.40	1.98	2.80	3.43	4.43	6.30
*	*	4.50	"	1.50	1.50	2.20	3.18	4.50	5.51	7.11	10.1
*	*	7.10	"	2.00	2.00	3.50	5.00	7.10	8.70	11.2	15.9
*	*	9.50	"	2.50	2.00	4.60	6.70	9.50	11.6	15.0	21.2
*	*	11.8	"	3.00	2.00	6.00	8.30	11.8	14.5	18.7	26.4
*	*	15.0	"	3.50	2.00	7.20	10.6	15.0	18.4	23.7	33.5
*	*	18.0	"	4.00	2.00	8.80	12.7	18.0	22.1	28.4	40.2
*	*	28.0	"	3.50	2.00	14.0	19.8	28.0	34.3	44.3	62.6
*	*	35.5	"	4.00	2.00	17.7	25.1	35.5	43.5	56.1	79.4
*	*	45.0	"	5.00	2.00	22.1	31.8	45.0	55.1	71.1	101
*	*	60.0	"	6.00	2.00	30.0	42.0	60.0	72.8	95.0	134
*	*	31.5	1"	5.00	2.80	15.9	22.3	31.5	38.6	49.8	70.4
*	*	40.0	"	6.00	2.80	19.7	28.3	40.0	49.0	63.3	89.5
*	*	56.0	"	8.00	2.80	27.7	40.3	56.0	68.6	89.0	125
*	*	80.0	"	6.00	2.80	39.4	57.0	80.0	98.0	126	179
*	*	112	"	8.00	2.80	55.4	79.0	112	137	177	250
*	*	106	2"	9.00	5.00	53.0	75.0	106	130	168	237
*	*	150	"	12.0	5.00	74.0	106	150	184	237	335
*	*	200	"	15.0	5.00	102	142	200	245	316	448
*	*	212	"	9.00	5.00	106	150	212	260	335	474
*	*	300	"	12.0	5.00	147	212	300	367	474	670
*	*	400	"	15.0	5.00	200	283	400	490	633	895
*	*	500	"	18.5	5.00	250	353	500	620	790	1,120

Illu. 2

130°

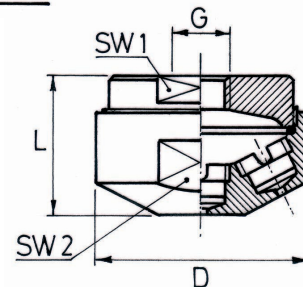

Type B-130°