

# Bundle Nozzle BL

# MC

## Characteristics

Bundle nozzles create a full cone spray pattern with micro-droplets, due to several merging hollow cones.

## Application

Cooling of gaseous and solid matters, Chlorine gas suppression, Fire protection as well as fostering of chemical reactions through surface enlargement.

## Material

Brass  
Stainless steel

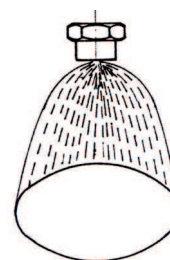

Full cone spray pattern

Illu. 1

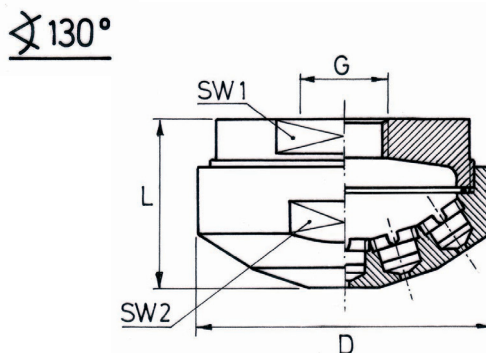

Type BL-130°

**Order example: (thread - type - spray angle - material) 1" - 56,0 - 130° - brass**

B = outlet bore, E = smallest section, bores vary slightly for different spray angles

Spray angle 130°	Type BL	Thread	Bore (mm)		Flow rate $\dot{V}$ (l/min.) at pressure p (bar)							Dimensions in mm			
			B	E	bar							D	L	SW1	SW2
					0.5	1	2	3	5	7	10				
*	<b>8.50</b>	1"	1.00	1.00	4.30	6.00	8.50	10.4	13.4	15.9	19.0	120	71	90	110
*	<b>22.4</b>	1"	2.00	2.00	11.2	15.8	22.4	27.4	35.4	41.9	50.1				
*	<b>37.5</b>	1"	3.00	2.00	18.8	26.5	37.5	45.9	59.3	70.2	83.9				
*	<b>56.0</b>	1"	4.00	2.00	28.0	40.0	56.0	68.6	89.0	105	125				
*	<b>14.0</b>	1"	1.00	1.00	7.00	9.90	14.0	17.1	22.1	26.2	31.3	150	74	120	150
*	<b>35.5</b>	1"	2.00	2.00	17.8	25.1	35.5	43.5	56.1	66.4	79.4				
*	<b>63.0</b>	1"	3.00	2.00	32.0	45.0	63.0	77.2	100	118	141				
*	<b>90.0</b>	1"	4.00	2.00	45.0	64.0	90.0	110	142	168	201				

Other bundle nozzles available on request!

Illu. 2

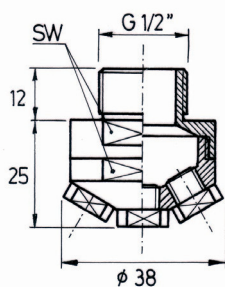

With screwed-in hollow cone or flat fan nozzles  
**BLA 7 - 1/2"**

Illu. 3

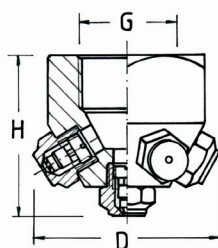

With screwed-in molecular atomizer  
**BLE 7 - 1/2"**

Illu. 4

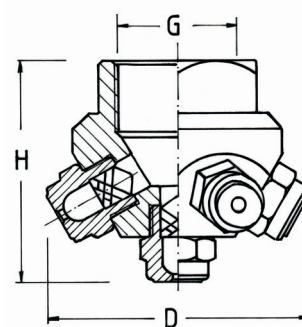

With screwed-in full cone nozzles  
**BLE 7 - 3/4" resp. 1"**