

Low-Noise Blowing Nozzles LRG, LRK + LRD

MC

Characteristics

All of MC's air slot nozzles on this page feature aerodynamically formed slots. This reduces noise level and air consumptions and also optimizes compressed air usage.

MC's air slot nozzles comply with OSHA-standards.

Application

Steel work
Food industry

Material

Stainless steel
Brass

Type	Dimensions in mm				
	G	L	D	d	SW
LRG					
4	1/2"	29	25	19	22
7	1/2"	29	25	19	22
10	1/2"	29	25	19	22
14	3/4"	42	42	34	38
20	1"	52	64	56	60
LRK	G	L ₂	D ₂	d ₃	SW
4	1/2"	73	40	19	22
7	1/2"	73	40	19	22
10	1/2"	73	40	19	22
14	3/4"	86	62	34	38
20	1"	112	86	56	60
LRD	G	L ₁	D ₁	d ₁	d ₂
12	1/2"	36	25	7	19
17	3/4"	49	42	19	34
25	1"	59	64	34	56

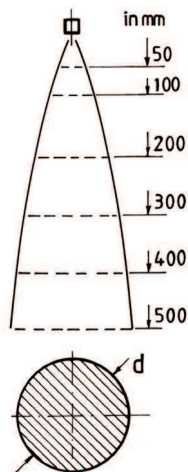

Air distribution

		Type LRG + LRK					Type LRD		
		4	7	10	14	20	12	17	25
Replaces open pipe-Ø	mm	4	7	10	14	20	12	17	25
Air consumption Nm ³ /h	2 bar	10.0	29.80	49.80	93.00	182.0	62.70	142.8	275.60
	4 bar	16.5	49.50	82.00	175.0	343.5	103.3	257.0	518.50
	5 bar	21.0	57.00	95.00	216.0	420.0	120.0	311.0	636.00
	6 bar	26.5	71.50	114.0	250.0	500.0	145.0	364.0	750.00
	8 bar	33.2	90.20	149.0	340.1	650.1	183.5	476.4	990.60
	10 bar	40.0	106.1	180.0	412.0	804.1	224.0	587.2	1228.3
Noise level dB(A) at 1 m distance	2 bar	75.3	83.0	85.60	91.10	96.10	88.30	92.10	97.30
	4 bar	80.0	87.0	90.60	96.70	101.2	93.30	97.60	102.5
	5 bar	82.0	89.0	92.00	99.00	104.0	94.80	100.0	105.0
	6 bar	83.6	90.8	95.00	100.7	105.0	96.30	101.7	106.3
	8 bar	86.2	93.0	97.60	103.5	107.3	99.00	103.0	107.7
	10 bar	87.5	94.6	100.0	105.4	109.8	100.3	104.5	109.1
Blowing force N (Kp) at 200 mm distance	2 bar	1.40	4.10	6.30	11.8	20.0	8.10	18.1	31.80
	4 bar	2.60	7.80	12.1	23.6	51.7	15.3	35.7	75.30
	5 bar	3.20	9.60	15.0	30.0	68.0	19.0	45.0	98.00
	6 bar	4.00	11.8	18.3	35.0	82.9	23.6	53.3	117.9
	8 bar	5.20	15.3	24.0	47.3	114.1	31.0	71.2	161.9
	10 bar	6.30	19.1	30.0	58.3	145.4	38.7	88.9	205.2
Air distribution Ø in mm at a distance of	50 mm	95.0	95.0	95.0	140	200	95.0	140	200
	100 mm	140	140	140	200	260	140	200	260
	200 mm	190	190	190	240	315	190	240	315
	300 mm	235	235	235	280	370	235	280	370
	400 mm	280	280	280	325	445	280	325	445
	500 mm	330	330	330	365	485	330	365	485
Air velocity m/s at a distance of	50 mm	108	116	125	130	139	140	146	155
	100 mm	86.0	96.0	105	108	110	113	118	126
	200 mm	51.0	54.0	57.0	61.0	63.0	64.0	67.0	72.0
	300 mm	39.0	40.0	44.0	46.0	48.0	49.0	51.0	55.0
	400 mm	34.0	36.0	38.0	40.0	42.0	43.0	45.0	48.0
	500 mm	31.0	33.0	35.0	37.0	39.0	39.0	41.0	44.0

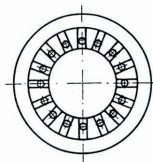

Illu. 1 Type LRG

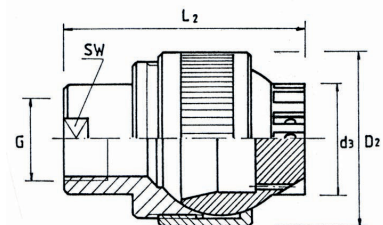
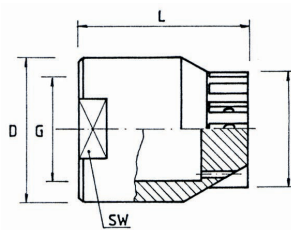

Illu. 2 Type LRK, pivoting by 60°

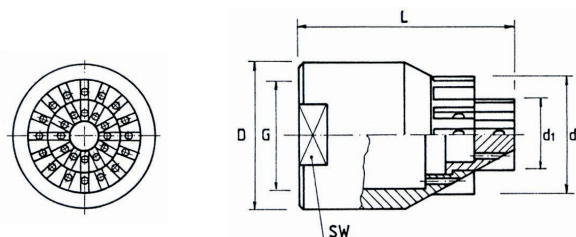

Illu. 3 Type LRD