

Solid Stream Air/Steam Nozzle D

MC

Characteristics

High flow intensity with maximum force of impact. Smooth, tightly bundled, powerful air flow.

Application

Blowing off
Blow-down
Cooling
Cleaning
Drying

Material

Brass
Stainless steel



Air jet

Thread	Dimensions (mm)		
	L	L1	SW
R 1/8"	17.5	6.5	14
R 1/4"	22	10.0	14
R 3/8"	25	10.0	17
R 1/2"	32	13.0	22
G 3/4"	38	15.0	30
G 1"	50	17.0	36

R = DIN 2999
G = DIN 228

Illu. 1

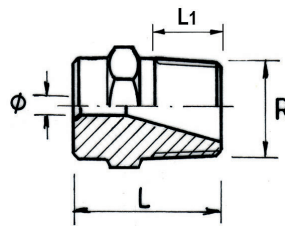

Up to type R 1/2"

Illu. 2

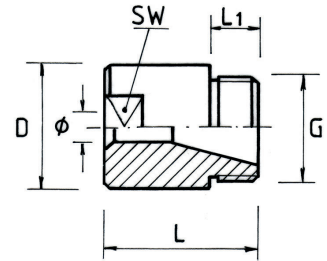

From type G 3/4"

Flow rate at compressed air and saturated steam capacity

Male thread R DIN 2999	Type Bore-Ø (mm)	Compressed air capacity in (Nm³/h) 20°C at pressure p (bar)								Saturated steam capacity in kg/h at pressure p (bar)							
		bar 1	bar 2	bar 3	bar 4	bar 5	bar 6	bar 7	bar 8	bar 1	bar 2	bar 3	bar 4	bar 5	bar 6	bar 7	bar 8
1/4"	D 0.5	0.27	0.40	0.54	0.67	0.81	0.94	1.08	1.22	0.21	0.31	0.42	0.53	0.64	0.74	0.84	0.95
	D 0.8	0.69	1.03	1.38	1.72	2.07	2.42	2.76	3.10	0.54	0.80	1.08	1.35	1.62	1.89	2.16	2.43
	D 1.0	1.07	1.61	2.14	2.67	3.22	3.75	4.30	4.85	0.84	1.26	1.68	2.10	2.55	2.95	3.36	3.78
	D 1.2	1.55	2.33	3.10	3.88	4.65	5.40	6.20	7.00	1.22	1.83	2.43	3.05	3.65	4.25	4.85	5.45
	D 1.5	2.42	3.64	4.85	6.05	7.25	8.50	9.70	10.9	1.90	2.85	3.80	4.75	5.70	6.65	7.60	8.55
	D 1.8	3.50	5.25	7.00	8.70	10.4	12.2	14.0	15.7	2.74	4.10	5.60	6.80	8.15	9.50	10.9	12.3
	D 2.0	4.30	6.45	8.60	10.7	12.9	15.2	17.2	19.4	3.36	5.05	6.72	8.40	10.1	11.8	13.5	15.2
	D 2.5	6.72	10.1	13.5	16.8	20.2	23.6	27.0	30.3	5.28	7.90	10.6	13.2	15.8	18.5	21.2	23.7
3/8"	D 3.0	9.70	14.5	19.4	24.2	29.2	34.0	38.8	43.6	7.60	11.4	15.2	19.0	22.8	26.6	30.4	34.2
	D 3.5	13.2	19.8	26.4	33.0	39.6	46.3	53.0	59.3	10.3	15.5	20.6	25.7	30.9	36.0	41.2	46.4
	D 4.0	17.2	25.8	34.5	43.0	51.7	60.2	69.0	77.5	13.5	20.3	27.0	33.7	40.5	47.0	54.0	61.0
	D 4.5	21.7	32.5	43.5	54.2	65.0	76.0	86.0	97.0	17.1	25.6	34.2	42.7	51.3	60.0	68.5	77.0
1/2"	D 5.0	26.8	40.2	53.5	63.5	80.2	94.0	107	121	21.0	31.5	42.0	52.5	63.0	73.5	84.0	94.5
	D 6.0	32.5	48.7	65.0	81.2	97.5	114	130	146	30.4	45.6	60.8	76.0	91.0	106	121	137
	D 7.0	52.8	79.0	105	132	159	185	212	237	41.3	62.0	83.0	104	124	145	168	186
	D 8.0	69.0	103	138	172	207	242	276	310	54.0	81.0	108	135	162	189	216	243
3/4"	D 9.0	87.0	130	174	217	261	305	348	392	68.0	102	136	170	204	238	272	306
	D 10	107	161	214	267	322	375	430	485	84.0	126	168	210	255	295	336	378
	D 11	130	195	260	325	390	455	520	585	102	153	204	255	306	358	408	460
1"	D 12	155	233	310	388	465	542	620	700	121	185	242	303	364	424	485	545
	D 13	182	273	365	455	545	638	728	820	143	215	286	358	430	500	572	642
	D 14	212	317	425	530	635	740	850	955	165	247	330	414	495	579	660	743
	D 15	242	364	485	605	725	850	970	1090	190	285	380	475	570	665	760	855
1"	D 16	276	415	550	690	825	965	1100	1240	216	324	432	540	648	755	865	970