

Bayonet Nozzles BF and BZ

MC

Flat fan bayonet nozzle BF

Material: brass, stainless steel, plastic, others on request

┌ └ Spray angle differs above the dotted line (smaller).

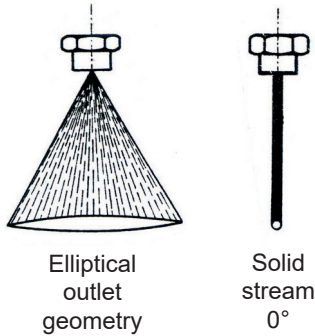

Spray angles available
0°-15°-25°-40°-60°-90°-120°
others on request

A = Äquivalenter Bohrungsdurchmesser

Code resp. size	A Ø (mm)	Flow rate \dot{V} (l/min.) at pressure p (bar)												
		bar 0.35	bar 0.5	bar 0.7	bar 1	bar 1.5	bar 2	bar 3	bar 4	bar 5	bar 7	bar 10	bar 15	bar 20
BF 1	0.6	0.13	0.16	0.19	0.23	0.28	0.32	0.39	0.46	0.51	0.60	0.72	0.88	1.02
BF 1.5	0.8	0.20	0.24	0.29	0.34	0.42	0.48	0.59	0.68	0.76	0.90	1.08	1.32	1.53
BF 2	0.9	0.27	0.32	0.38	0.46	0.56	0.64	0.79	0.91	1.02	1.21	1.44	1.77	2.04
BF 2.5	1.0	0.34	0.40	0.48	0.57	0.70	0.81	0.99	1.14	1.27	1.51	1.80	2.21	2.55
BF 3	1.1	0.40	0.48	0.57	0.68	0.84	0.97	1.18	1.37	1.53	1.81	2.16	2.65	3.06
BF 4	1.3	0.54	0.64	0.76	0.91	1.12	1.29	1.58	1.82	2.04	2.41	2.88	3.53	4.08
BF 5	1.5	0.67	0.81	0.95	1.14	1.40	1.61	1.97	2.28	2.55	3.02	3.60	4.41	5.10
BF 6	1.6	0.81	0.97	1.14	1.37	1.67	1.93	2.37	2.74	3.06	3.62	4.32	5.30	6.12
BF 8	1.8	1.08	1.29	1.53	1.82	2.23	2.58	3.16	3.65	4.08	4.82	5.77	7.06	8.15
BF 9	1.9	1.21	1.45	1.72	2.05	2.51	2.90	3.55	4.10	4.59	5.43	6.49	7.95	9.17
BF 10	2.0	1.35	1.61	1.91	2.28	2.79	3.22	3.95	4.56	5.10	6.03	7.21	8.83	10.2
BF 12.5	2.2	1.69	2.01	2.38	2.85	3.49	4.03	4.93	5.70	6.37	7.54	9.01	11.0	12.7
BF 15	2.4	2.02	2.42	2.86	3.42	4.19	4.84	5.92	6.84	7.65	9.05	10.8	13.2	15.3
BF 17.5	2.6	2.36	2.82	3.34	3.99	4.89	5.64	6.91	7.98	8.92	10.6	12.6	15.5	17.8
BF 20	2.8	2.70	3.22	3.81	4.56	5.58	6.45	7.90	9.12	10.2	12.1	14.4	17.7	20.4
BF 25	3.2	3.37	4.03	4.77	5.70	6.98	8.06	9.87	11.4	12.7	15.1	18.0	22.1	25.5
BF 30	3.6	4.05	4.84	5.72	6.84	8.37	9.67	11.8	13.7	15.3	18.1	21.6	26.5	30.6
BF 35	3.8	4.72	5.64	6.67	7.98	9.77	11.3	13.8	16.0	17.8	21.1	25.2	30.9	35.7
BF 40	4.0	5.39	6.45	7.63	9.12	11.2	12.9	15.8	18.2	20.4	24.1	28.8	35.3	40.8
BF 45	4.2	6.00	7.20	8.00	9.50	11.5	14.0	17.5	20.5	22.5	27.5	32.5	30.0	35.0
BF 50	4.4	6.74	8.06	9.54	11.4	14.0	16.1	19.7	22.8	25.5	30.2	36.0	44.1	51.0
BF 60	4.8	8.09	9.67	11.4	13.7	16.8	19.3	23.7	27.4	30.6	36.2	43.3	53.0	61.2
BF 70	5.2	9.44	11.3	13.4	16.0	19.5	22.6	27.6	31.9	35.7	42.2	50.5	61.8	71.4
BF 80	5.6	10.8	12.9	15.3	18.2	22.3	25.8	31.6	36.5	40.8	48.3	57.7	70.6	81.6

Illu. 1

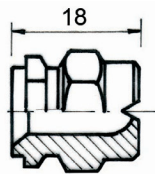

Order example: (code - spray angle - material) BF 5 - 50° - V2A

For adapters and accessories see page 8.9.

Tongue-shaped bayonet nozzle BZ

Material: brass, stainless steel, plastic, others on request

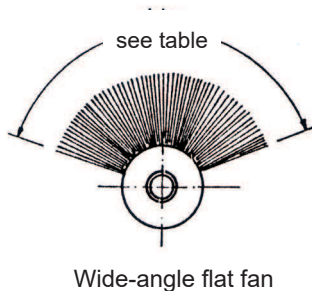

Illu. 2

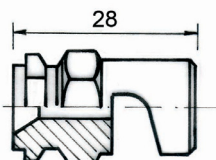

Code resp. size	A Ø (mm)	Flow rate \dot{V} (l/min.) at pressure p (bar)								Angle at p			
		bar 0.2	bar 0.3	bar 0.5	bar 0.7	bar 1	bar 1.5	bar 2	bar 3	bar 4	bar 0.5	bar 1.5	bar 4
BZ 0.5	0.6					0.20	0.25	0.30	0.40	0.50		90°	120°
BZ 1	0.7				0.30	0.35	0.40	0.50	0.60	0.75		105°	125°
BZ 1	0.8				0.40	0.45	0.50	0.60	0.75	1.00		110°	130°
BZ 1.5	1.0			0.50	0.60	0.70	0.80	1.00	1.20	1.50	75°	110°	130°
BZ 2	1.2			0.60	0.70	0.90	1.00	1.30	1.50	2.00	85°	115°	130°
BZ 2.5	1.3		0.70	0.80	0.90	1.20	1.30	1.60	2.00	2.50	85°	120°	135°
BZ 3	1.4		0.80	0.90	1.20	1.40	1.60	2.00	2.30	3.00	85°	110°	125°
BZ 4	1.6		1.00	1.20	1.50	1.90	2.20	2.60	3.00	4.00	95°	125°	130°
BZ 5	1.8	1.00	1.30	1.60	1.90	2.30	2.70	3.30	3.80	4.50	115°	130°	140°
BZ 7.5	2.3	1.50	2.00	2.50	3.00	3.50	4.00	5.00	5.50	7.00	100°	120°	135°
BZ 10	2.6	2.00	2.50	3.00	4.00	4.50	5.00	6.50	7.50	9.50	115°	135°	145°
BZ 12	2.9	2.50	3.00	4.00	4.50	5.50	6.50	8.00	9.00	11.0	130°	140°	155°
BZ 15	3.3	3.00	4.00	5.00	5.50	7.00	8.00	10.0	11.0	14.0	100°	115°	125°
BZ 18	3.6	3.50	4.50	5.50	7.00	8.00	9.50	11.0	14.0	16.0	105°	120°	130°
BZ 20	3.8	4.00	5.00	6.50	7.50	9.00	10.5	13.0	15.0	18.0	110°	120°	135°
BZ 22	3.9	4.50	6.00	7.00	8.00	10.0	12.0	14.0	17.0	20.0	110°	125°	135°
BZ 24	4.0	5.00	6.50	7.50	9.00	11.0	13.0	16.0	18.0	22.0	115°	130°	145°
BZ 27	4.4	5.50	7.00	8.50	10.0	12.0	14.0	17.0	21.0	25.0	120°	135°	150°

Order example: (code - material) BZ 2.5 - MS

For adapters and accessories see page 8.9.