

Nozzles with bayonet fastening,
exchangeable in seconds without tools

Characteristics

The nozzle is adjusted and sits tight with just one 90° turn.
The nozzle is exchangeable and adjustable within seconds and without tools.
A click signalizes the nozzle's correct position when screwed-in.

Application

All nozzle types, spray patterns and adapters are at choice.

Material

Brass
Steel
Stainless steel
Other materials on request

Max. pressure: in brass 14 bar
in stainl. steel 24 bar

- 1 Welding bayonet basic body with and without pipe radius
- 2 O-ring made from NBR or Viton
- 3 Flat fan nozzle BF

The installation's total length is calculated as follows:
(length of basic body) + (length of nozzle) - 8 mm

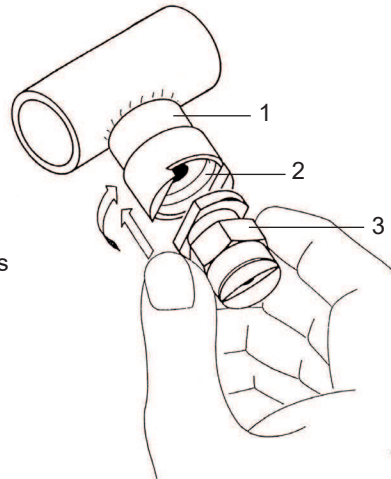

Bayonet basic body

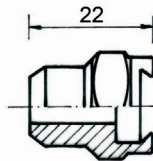

Welding bayonet basic body **BA**

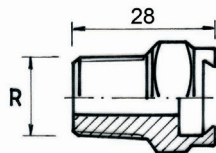

Male thread bayonet basic body **BR**

- Thread R 1/8" x 7 mm
- R 1/4" x 10 mm
- R 3/8" x 10 mm

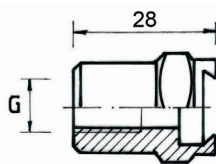

Female thread bayonet basic body **BI**

- Thread G 1/8" x 7 mm
- G 1/4" x 10 mm

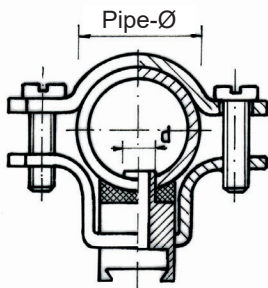

Mounting clamp **PB**
on request

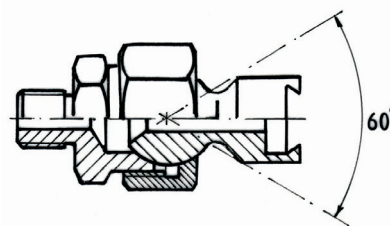

Ball joint **K 25 - BB**
on request