

Limited rotating nozzle (with stainless steel slide bearing)

Characteristics

A patented barke turbine ensures for a slow rotation of the nozzle (about 5-30 U/min.), even if pump pressure increases.

The nozzle is made up of just 3, easily dismantled parts.

The short and compact design allows for various connection possibilities and flow rates.

Nozzle without interference-prone ball bearing, but with self-lubricating stainless steel slide bearing.

Horizontal and vertical installation possible.

Application

Cleaning of
Tanks
Barrels
Containers

Material

Stainless steel 1.4305 or
1.4404
Other materials
on request

Illu. 1

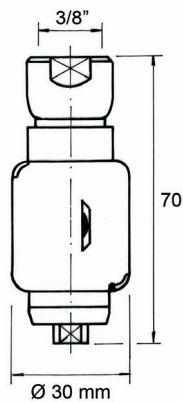

with
thread connection
type **RX ...**

Illu. 2

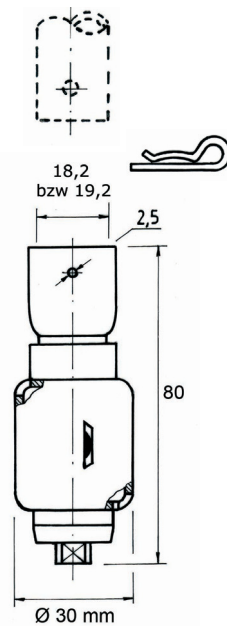

with
clamp connection
DN 18,2 RX ...
resp. **19,2 RX ...**

Illu. 3

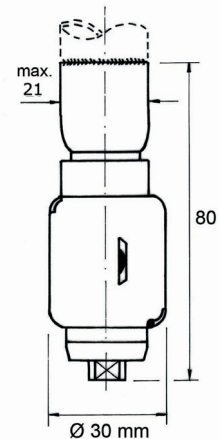

welded connection
D 21 S ... - RX ...,
pipe-Ø and
wall thickness information

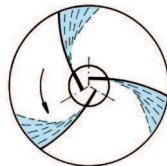
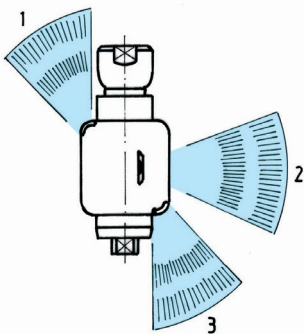

The larger the rotation velocity, the more the liquid fluid dissolves into a fog flag at increasing distance. Also, the cleaning force of impact decreases.

Rotating flat fans fog faster than rotating solid streams.

Order example: type, connection and material

Type	Flow rate \dot{V} (l/min.) at pressure p (bar)									Tank- Ø (m)
	bar 2	bar 3	bar 4	bar 5	bar 7	bar 10	bar 12	bar 15	bar 20	
RX 10	10,0	12,2	14,1	15,8	18,7	22,4	24,5	27,4	31,6	3
RX 15	15,0	18,3	21,1	23,7	28,1	33,6	36,8	41,0	47,4	3,5
RX 30	30,0	36,6	42,2	47,4	56,2	67,2	73,6	82,0	94,8	4
RX 45	45,0	54,9	63,3	71,1	84,3	101	110	123	142	5

Design with 3/4" connection on request

