

# High-Pressure Flat Fan Nozzle FHH

# MC

With carbide insert

## Characteristics

Sharp, uniform flat fan with extraordinary spray depth. The impact force's uniform distribution allows for a good cleaning result and a clean surface.

## Material

Stainless steel with carbide insert

## Application

High-pressure cleaning  
Spraying of abrasive media



Square impact area



Solid stream spray pattern

Illu. 1

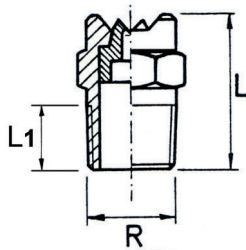

F-HH

With carbide insert

Illu. 2

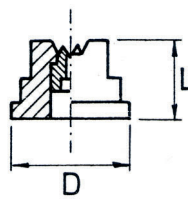

CF-HH

To be clamped

Illu. 3

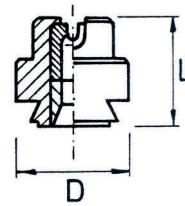

CFS-HH

Order example: (thread - type - spray angle) 1/4" - F-HH 0.53 - 90°

Spray angles available:

0°-5°-10°-15°-20°-25°-33°-40°-50°-65°-73°-80°-90°-100°-110°-120°

Type	Equi. Ø in mm	Flow rate $\dot{V}$ (l/min) at pressure p (bar)					Spray angle
		50 bar	100 bar	150 bar	200 bar	250 bar	
0.13	0.13	0.064	0.090	0.111	0.128	0.143	5° - 25°
0.15	0.15	0.094	0.123	0.162	0.187	0.209	5° - 25°
0.18	0.18	0.128	0.181	0.221	0.255	0.286	5° - 65°
0.23	0.23	0.175	0.247	0.302	0.349	0.390	5° - 65°
0.28	0.28	0.273	0.385	0.472	0.545	0.609	5° - 73°
0.30	0.30	0.370	0.524	0.642	0.741	0.828	5° - 73°
0.33	0.33	0.400	0.566	0.693	0.800	0.895	5° - 90°
0.38	0.38	0.528	0.747	0.914	1.056	1.181	10° - 100°
0.41	0.41	0.626	0.865	1.064	1.252	1.400	10° - 100°
0.43	0.43	0.707	1.000	1.224	1.414	1.580	10° - 120°
0.46	0.46	0.805	1.136	1.934	1.606	1.799	10° - 120°
0.48	0.48	0.886	1.252	1.534	1.771	1.980	10° - 120°
0.53	0.53	1.077	1.523	1.866	2.154	2.409	10° - 120°
0.58	0.58	1.286	1.818	2.227	2.572	2.875	10° - 120°
0.66	0.66	1.609	2.276	2.778	3.219	3.599	10° - 120°
0.74	0.74	2.095	2.963	3.626	4.190	4.664	10° - 120°
0.79	0.79	2.414	3.414	4.181	4.828	5.396	10° - 120°
0.91	0.91	3.223	4.556	5.583	6.446	7.207	10° - 120°
1.10	1.10	4.833	6.834	8.370	9.665	10.806	20° - 120°
1.30	1.30	6.446	9.117	11.165	12.893	14.414	20° - 120°
1.46	1.46	8.056	11.393	13.953	16.112	18.013	20° - 120°
1.60	1.60	9.670	13.675	16.748	19.339	21.622	20° - 120°
1.70	1.70	11.279	15.951	19.536	22.558	25.221	20° - 120°
1.80	1.80	12.893	18.233	22.331	25.785	28.829	20° - 120°
1.90	1.90	14.502	20.509	25.118	29.004	32.428	20° - 120°
2.00	2.00	16.116	22.791	27.913	32.232	36.036	20° - 120°
2.16	2.16	17.725	25.067	30.701	35.451	39.635	20° - 120°
2.30	2.30	19.339	27.350	33.496	38.678	43.243	20° - 120°
2.36	2.36	20.948	29.626	36.264	41.897	46.842	20° - 120°
2.44	2.44	22.562	31.908	39.079	45.124	50.421	20° - 120°

Thread R	Type	Dimensions mm			
		L	L1	SW	D
	CF-HH	12.5	-	10	15
1/4"	F-HH	22	10	14	
1/8"	F-HH	22	10	14	

Also available with NPT-thread, up to size 2 also possible with R 1/8"