

Table of Contents

Page

1	Table of Contents	_____
2	MC's Product Spectrum	_____
3	Overview Cleaning doors, Dome covers, Manways	_____
4	Dome covers, Cleaning doors, Manways	_____
5	Dome covers and Hand holes	_____
6	Dome covers	_____
7	Dome cover DK (0.49 bar)	_____
8	Hand hole cover D 15 (0.5 bar) Dome cover D 22, 30 (0.5 bar)	_____
9	Dome cover DZ 22, 30 (0.5 bar) Dome cover DL 40, 50, 60 (0.02 bar)	_____
10	Dome cover DB 40, 50, 60 (0.02 bar) Dome cover DA 40, 50, 60 (0.02 bar)	_____
11	Dome cover DS 30, 40, 50 (unpress.)	_____
12	Cleaning door Ef 1, Ef 2, Ef 2S (0.02 bar - 0.49 bar) Cleaning door E 1, E 2, E 2S, upright (0.02 bar - 0.49 bar)	_____
13	Cleaning door EF 3 (0.49 bar) Cleaning door E 3, upright (0.49 bar)	_____
14	Cleaning door EF 4 (0.49 bar) Cleaning door E 4, upright (0.49 bar)	_____
15	Dome cover type M-G and M-GO (-1 bar + 3 bar)	_____
16	Dome cover type M-B and M-D1 (-1 bar + 1 bar or -1 bar + 6 bar)	_____
17	Dome cover type M-D2 (-1 bar to +10 bar)	_____
18	Terms of delivery and payment	

MC's Product Spectrum

For our product spectrum please visit

www.mc-gmbh.eu

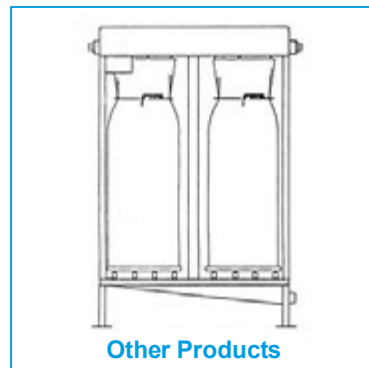
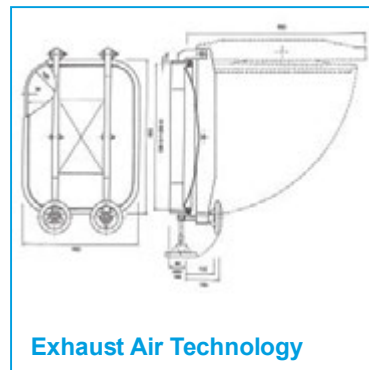
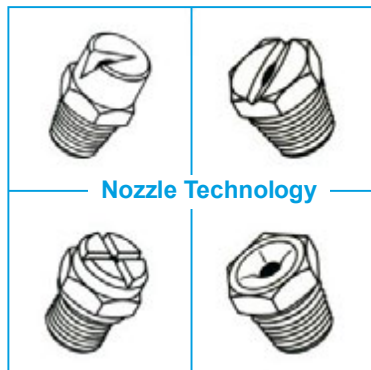

MC's cleaning doors, dome covers and manways made from stainless steel or steel weld extrusions for tank and plant construction in various forms

Please request mechanical drawings and other technical data!

Illu. 1

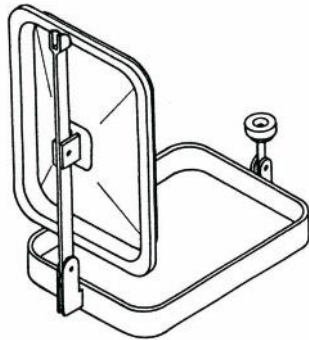

Cleaning door type EF
installed lengthwise or upright

Illu. 2

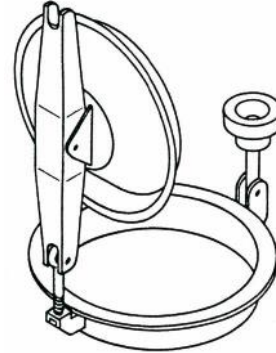

Dome cover type D

Illu. 3

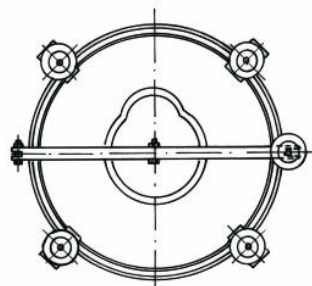

Dome cover

Type **DB** with swivelling handle and fasteners
Type **DA** with fasteners only

Type	Inside dimensions (mm)	Type upright	Inside dimensions (mm)	Extrusion height (mm)	Edge radius (mm)	Max. pressure p (bar)
EF 1	228 x 176	E 1	176 x 288	40	25	0.49
EF 2	316 x 248	E 2	248 x 316	40	25	0.49
EF 2S	402 x 288	E 2S	288 x 402	40	45	0.49
EF 3	420 x 310	E 3	310 x 420	50 + 100	100	0.49
EF 4	530 x 400	E 4	400 x 530	60 + 100	100	0.49
					Max. press. p (bar)	Max. press. p (bar)
D 15	Ø 150			45 + 90		0.35
D 22	Ø 220			45 + 90		0.35
D 30	Ø 300			45 + 90		0.35
D 40	Ø 400			45 + 90	DK 40 = 0.49 splash proof	
D 50	Ø 500			45 + 90	DK 50 = 0.49 splash proof	
D 60	Ø 600			45 + 90		splash proof
M-B (all -1/+1 bar)	M-G (with glass press. plate)	Max. press. (bar)	M-D 1	Max. press. (bar)	M-D 2	Max. press. (bar)
Ø 200						
Ø 250						
Ø 300			Ø 300	-1/+6	Ø 300	-1/+10
Ø 400	Ø 400	-1/+3	Ø 400	-1/+6	Ø 400	-1/+10
Ø 450	Ø 450	-1/+3	Ø 450	-1/+6	Ø 450	-1/+8
Ø 500	Ø 500	-1/+3	Ø 500	-1/+6	Ø 500	-1/+7.5
Ø 600	Ø 600	-1/+3	Ø 600	-1/+6	Ø 600	-1/+5.5
Ø 700					Ø 700	-1/+4
Ø 800						

Illu. 4

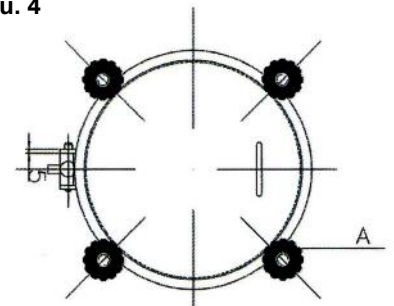

Dome cover
Types **M** max. pressure 10 bar
(see table)

Possible seals		
Material	Max. temperature	Application
Rubber	70°	Food
Silicon	160°	Food
NBR	100°	Oil
EPDM Neoprene	140° 120°	Acidic and alkaline cleaners
Viton	200°	Solvents

for stainless steel or steel tanks, opening to the outside



Dome cover

Type	Inside dim. in mm (Ø)	Extrusions height in mm			
		45	90	150	200
D 15	150	45	90		
D 22	220	45	90	150	200
D 30	300	45	90	120	
DL 40	400	45	90	150	200
DL 50	500	45	90	150	200



Cleaning doors for tanks

Type	Inside dim. L x H in mm	Extrusion height in mm		
		40	50	100
E 1	176 x 228	40		
E 2	248 x 316	40		
E 2S	288 x 408	40		
E 3	310 x 420		50	100
E 3S	400 x 450	40		
E 4	400 x 530		60	100
Ef 1	228 x 176	40		
Ef 2	316 x 248	40		
Ef 2S	408 x 288	40		
Ef 3	420 x 310		50	100
Ef 3S	450 x 400	40		
Ef 4	530 x 400		60	100

Material: Stainless steel design in 1.4301 oder 1.4404, electropolish, star handle made from stainless steel or plastic; steel design made from St 37, primed

Delivery: With or without extrusion; with or without swivelling design, or single parts available on request

Seals: Rubber, Silicon, NBR, EPDM and Viton

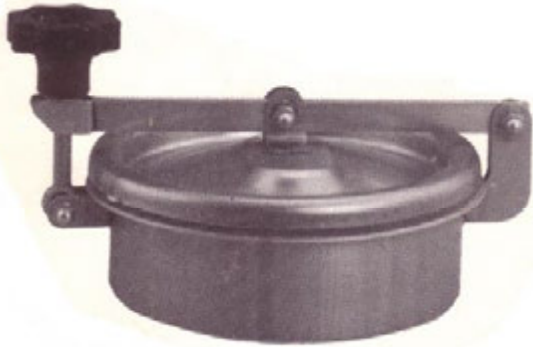

**Dome cover
and hand hole with swivelling handle**

Pressure up to 0.49 bar

Type	Inside-Ø	Extrusion height in mm			
D 15	150	45	90		
D 22	220	45	90	150	200
D 30	300	45	90	150	200



**Dome cover
with cross-bar and two fastening screws**

Pressure up to 0.49 bar

Type	Inside-Ø	Extrusion height in mm			
DZ 22	220	45	90	150	200
DZ 30	300	45	90	120	200

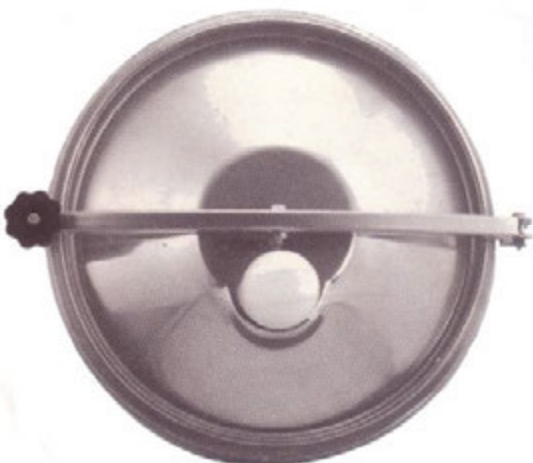

Dome cover with swivelling handle

Without pressure

Type	Inside-Ø	Ex. height in mm		
DL 40	400	45	90	150
DL 50	500	45	90	150
DL 60	600	45	90	150



Dome cover with fastening clamps

Max. pressure 0.2 bar

Type	Inside-Ø	Extrusion height in mm			Number of clamps
		45	90	150	
DA 40	400	45	90	150	4
DA 50	500	45	90	150	6
DA 60	600	45	90	150	8



Dome cover with quick fastener

Max. pressure 0.2 bar

Type	Inside-Ø	Ext. height in mm		
DS 30	300	45	90	150
DS 40	400	45	90	150
DS 50	500	45	90	150

Dome Cover DK

MC

Dome cover DK only opens to the outside

Material: Stainless steel 1.4301 or 1.4404



Dome cover DK



Dome cover DK with drip plate

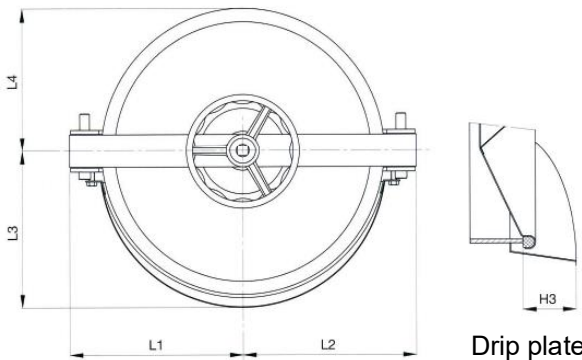
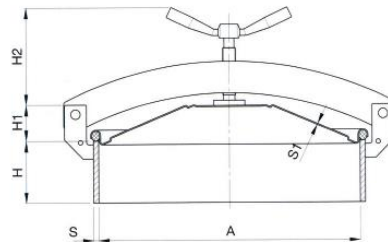
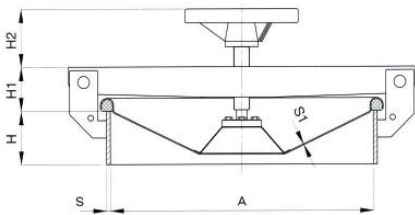

DK 400

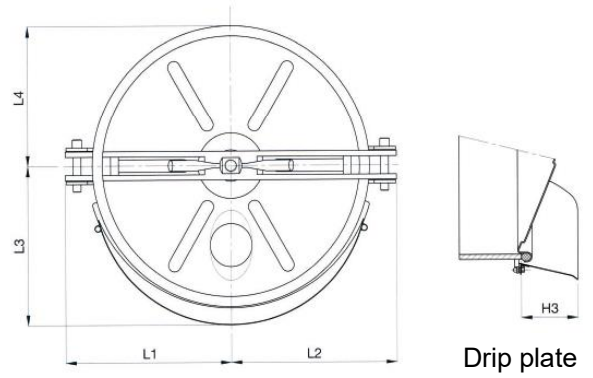

DK 500

Type	Max. pressure in bar	H	H1	H2	H3	L1	L2	L3	L4	S	S1
DK 400	0.49	80	65	90	90	264	264	238	218	6	1.5
DK 500	0.49	120	65	165	110	317	317	300	265	10	1.5

Pressure up to 0.35 bar

Material: Stainl. steel V2A or V4A, polished

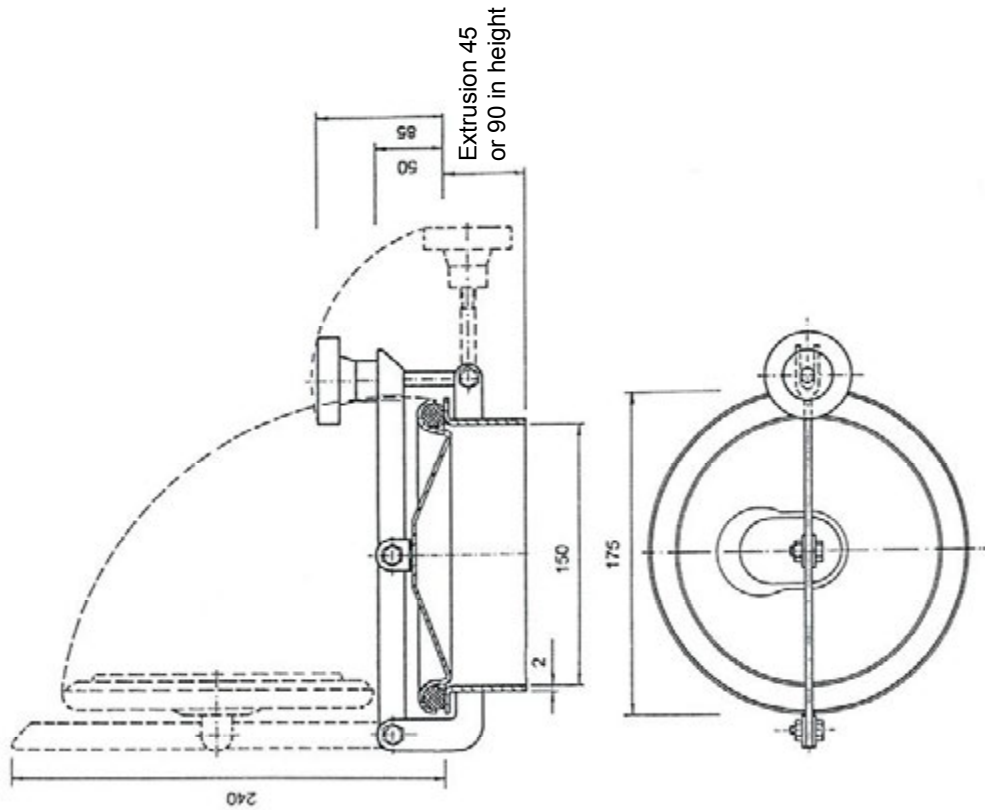

Illu. 1

Pressure up to 0.35 bar

Material: stainl. steel V2A or V4A, polished
Alternative: Weld extrusion made from steel

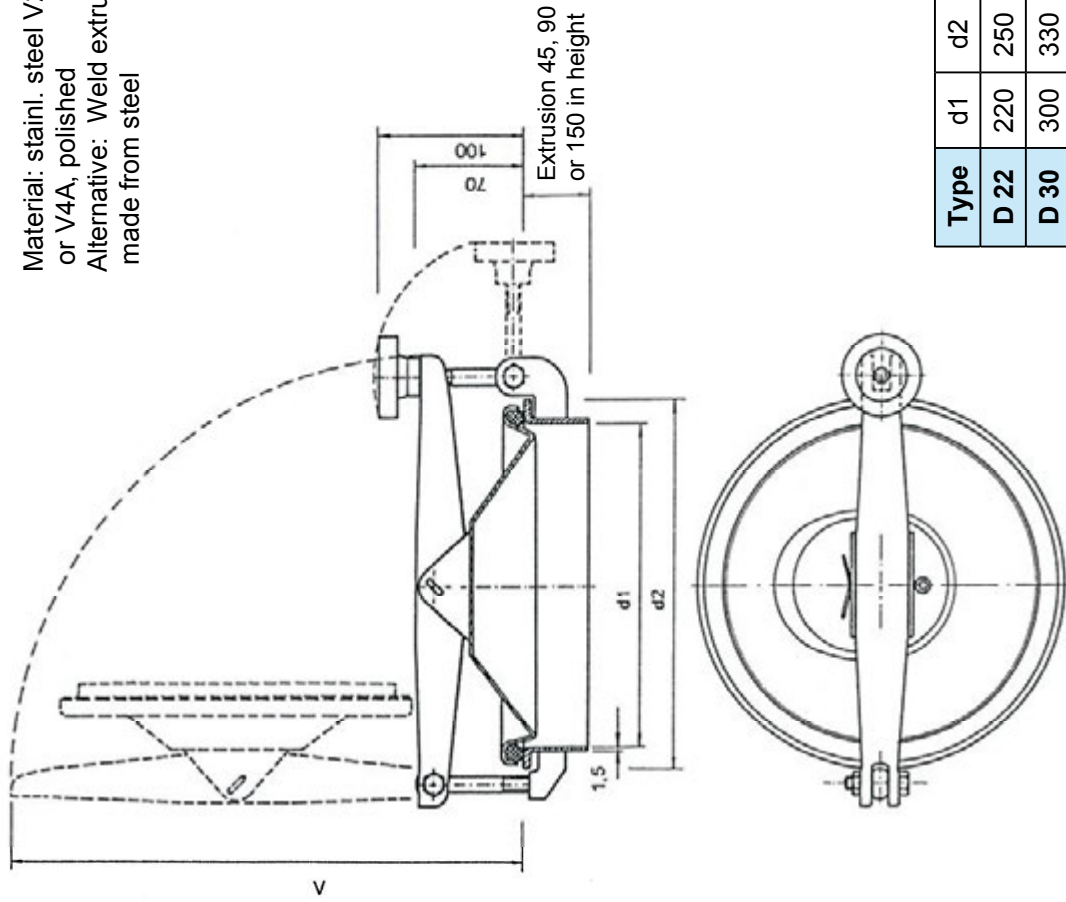

Type	d1	d2	A
D 22	220	250	320
D 30	300	330	400

Illu. 2

MC

Dome Covers DZ 22, 30

Pressure up to 0.35 bar

Material: Stainl. steel V2A
or V4A, polished
Alternative: Weld extrusion
made from steel

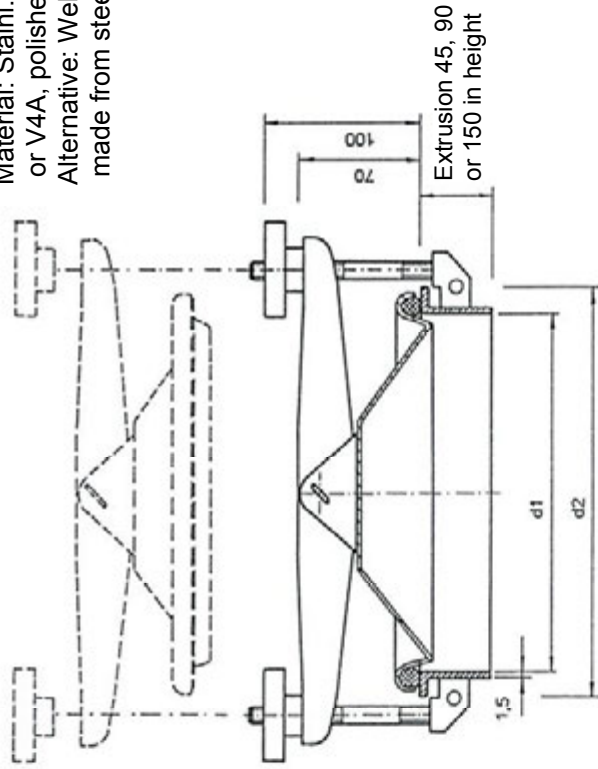

Type	d1	d2
DZ 22	220	250
DZ 30	300	330

Illu. 3

Dome Covers DL 40, 50, 60 MC

Unpressurized/Splash proof

Material: Stainl. steel V2A
or V4A, polished
Alternative: Weld extrusion
made from steel

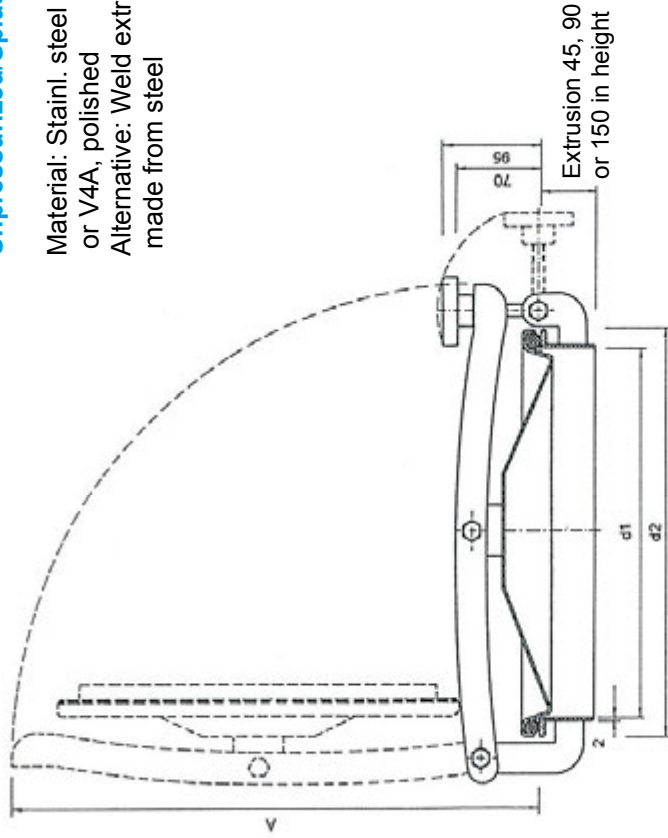

Type	d1	d2	A
DL 40	400	430	470
DL 50	500	530	570
DL 60	600	630	670

Illu. 4

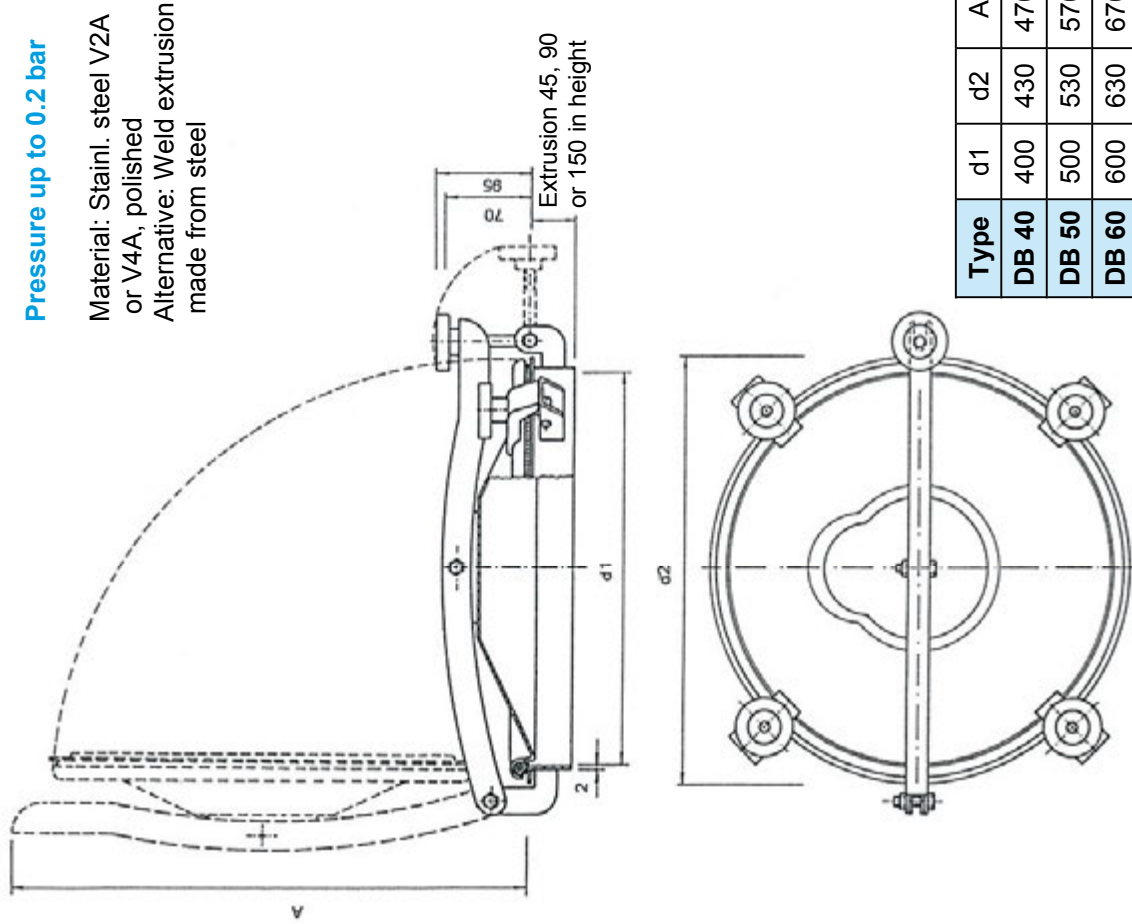

Pressure up to 0.2 bar

Material: Stainl. steel V2A
or V4A, polished
Alternative: Weld extrusion
made from steel

Extrusion 45, 90
or 150 in height

Illu. 5

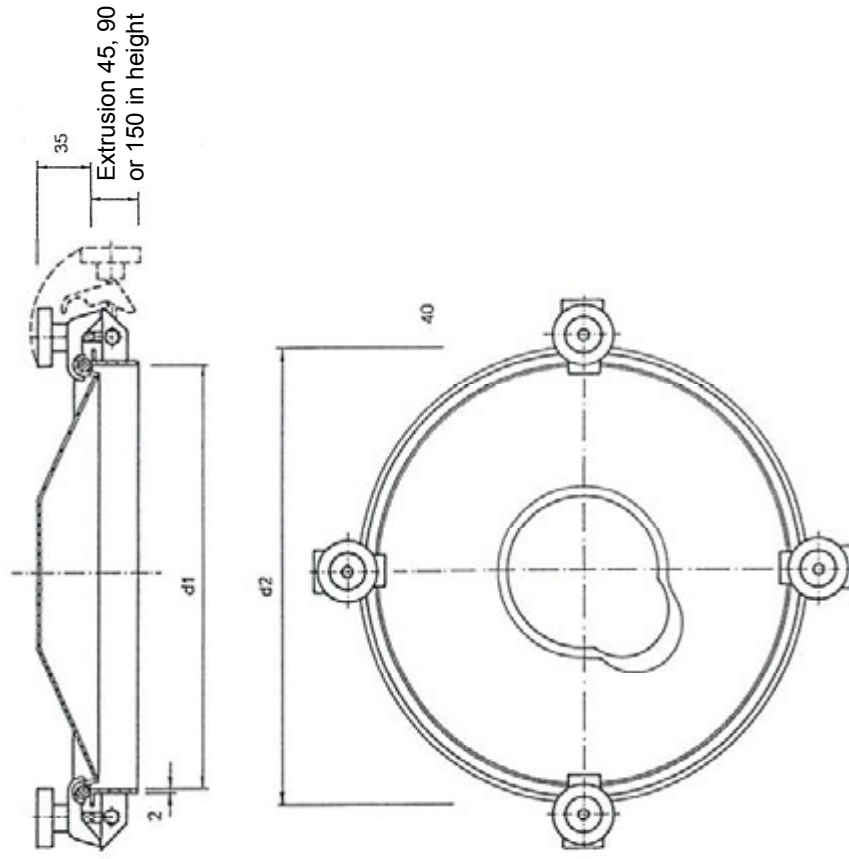

Extrusion 45, 90
or 150 in height

Pressure up to 0.2 bar

Material: Stainl. steel V2A
or V4A, polished
Alternative: Weld extrusion
made from steel

Illu. 6

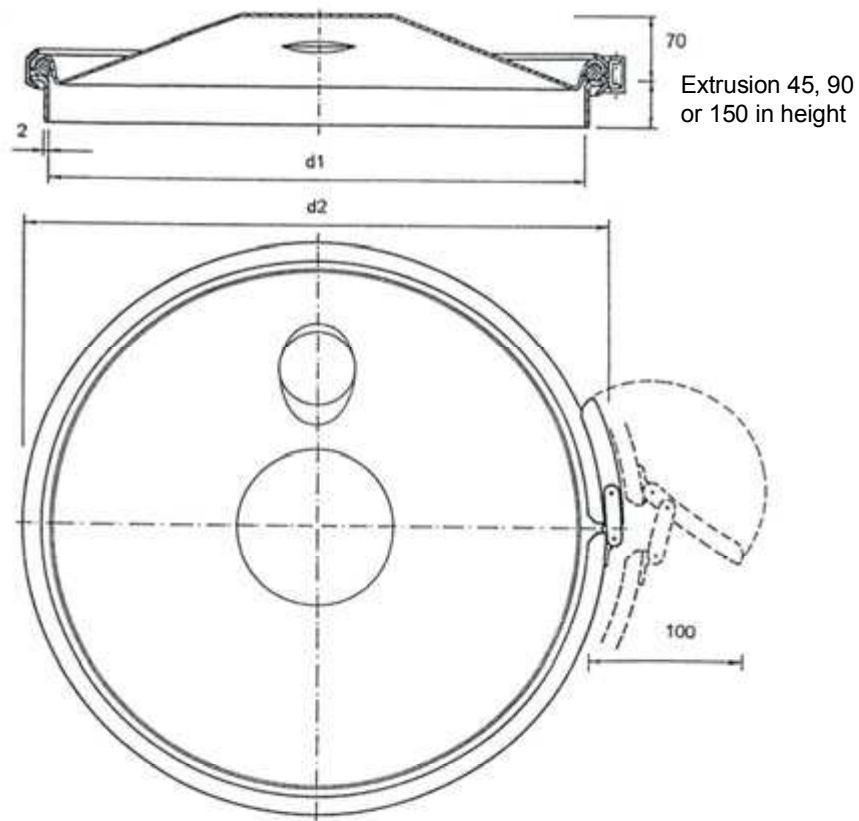

With stress
unpressurized

Material: Stainl. steel V2A
or V4A, polished
Alternative: Weld extrusion
made from steel

Type	d1	d2
DS 30	300	330
DS 40	400	430
DS 50	500	530

Illu. 7

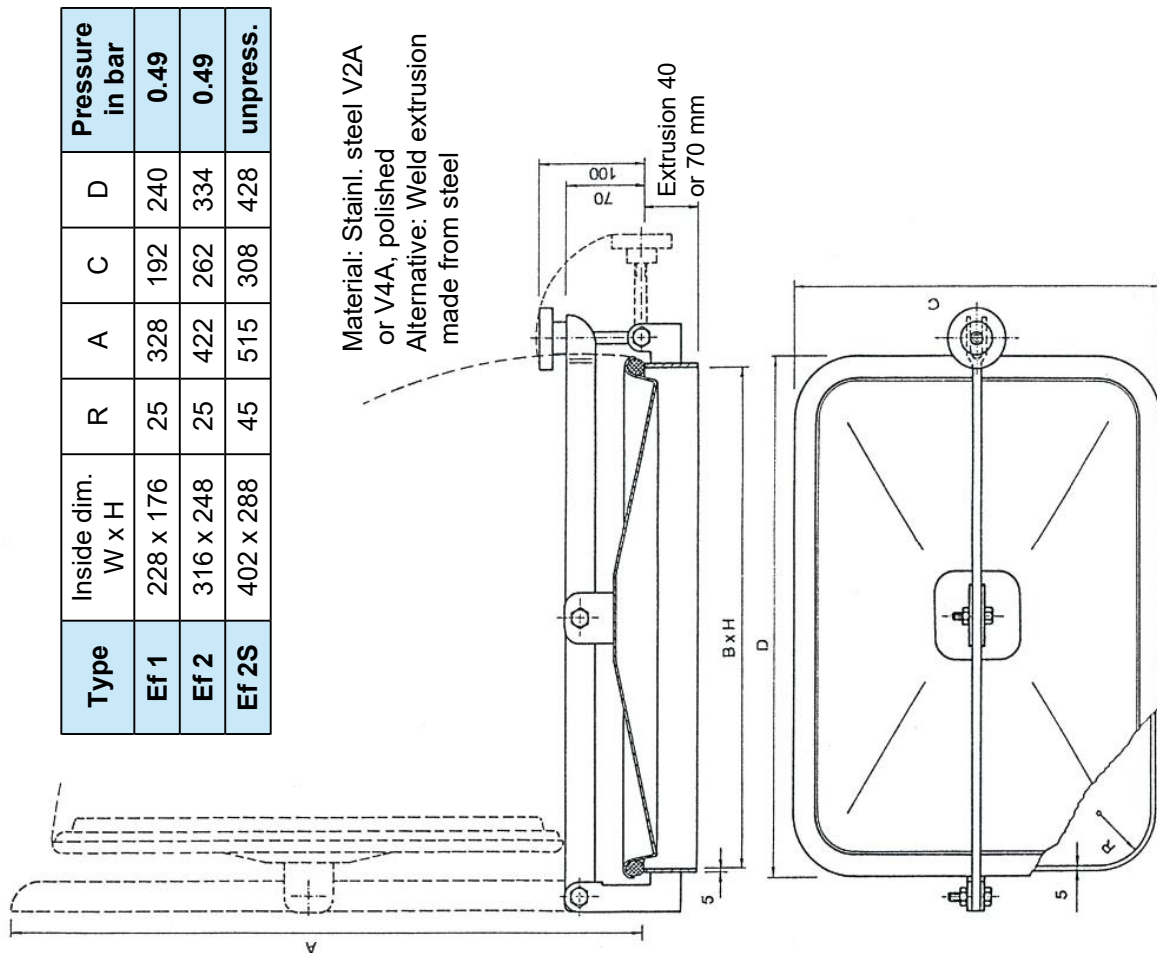

Type	Inside dim. W x H	R	A	C	D	Pressure in bar
Ef 1	228 x 176	25	328	192	240	0.49
Ef 2	316 x 248	25	422	262	334	0.49
Ef 2S	402 x 288	45	515	308	428	unpress.

Illu. 8

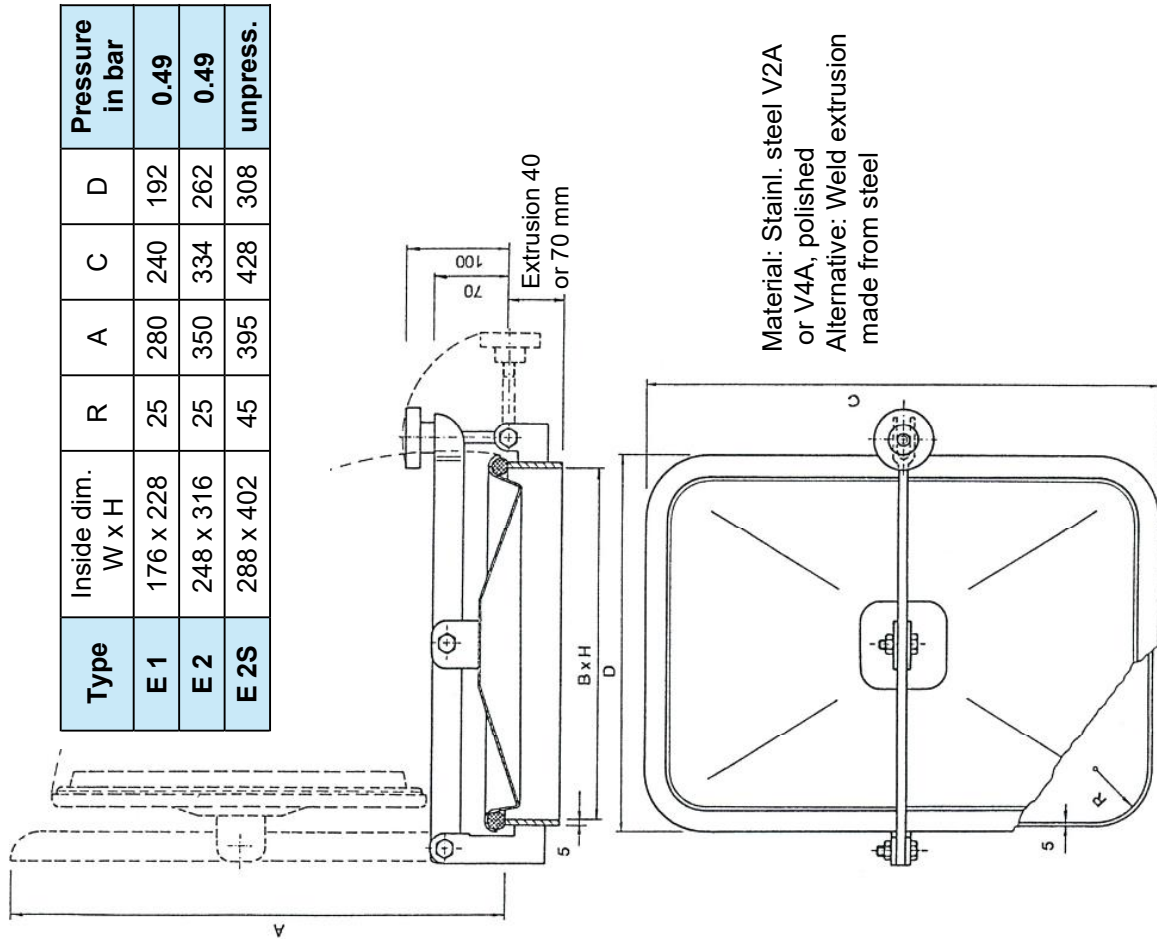

Type	Inside dim. W x H	R	A	C	D	Pressure in bar
E 1	176 x 228	25	280	240	192	0.49
E 2	248 x 316	25	350	334	262	0.49
E 2S	288 x 402	45	395	428	308	unpress.

Illu. 9

MC

Cleaning Door EF 3

Inside dim. W 420 x H 310 mm

Pressure up to 0.49 bar

Material: Stainl. steel V2A
or V4A, polished

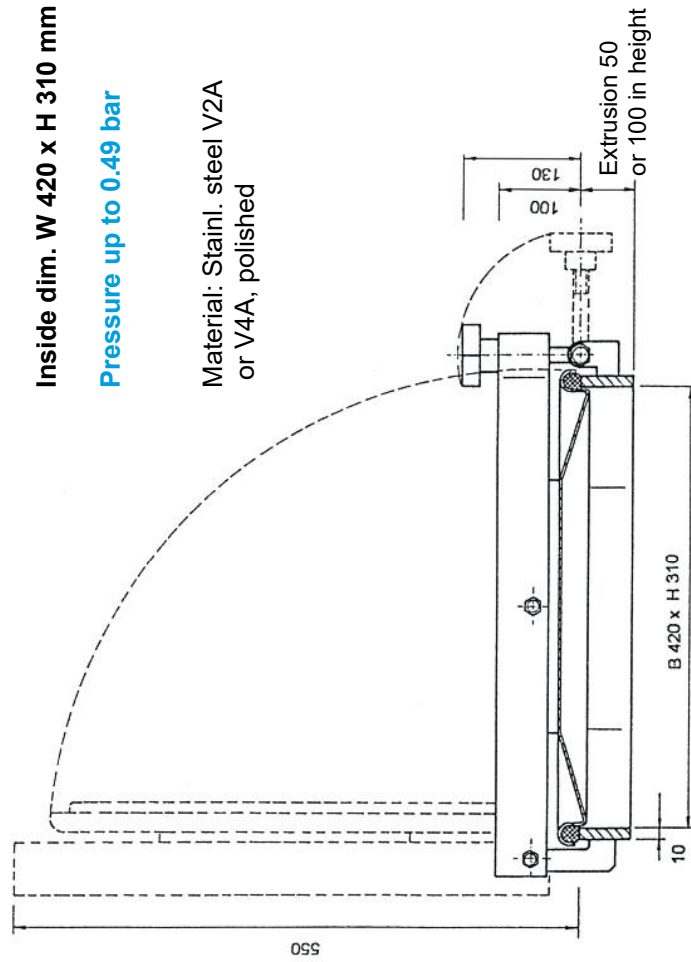

Illu. 10

Cleaning Door E 3, upright

MC

Inside dim. W 310 x H 420 mm

Pressure up to 0.49 bar

Material: Stainl. steel V2A
or V4A, polished

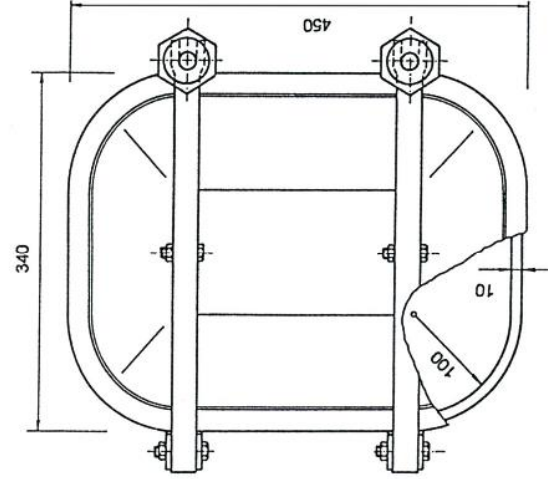
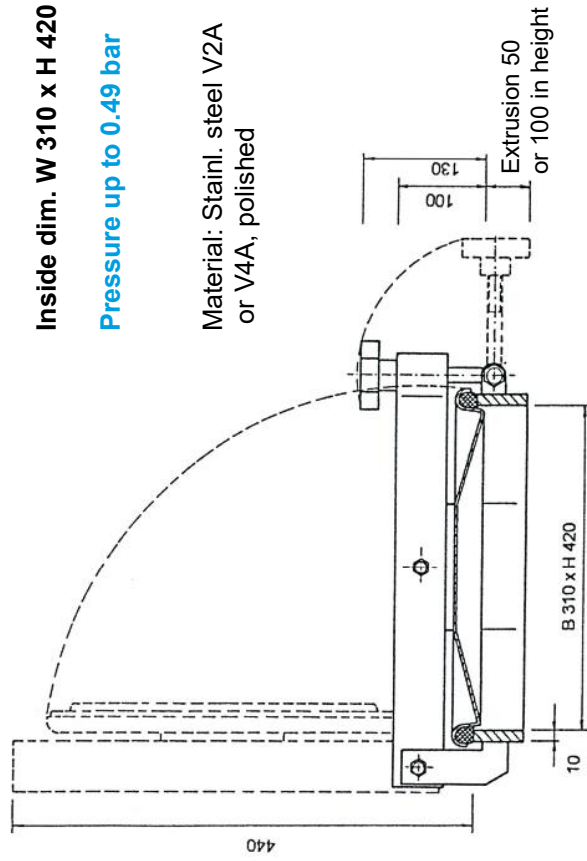

Illu. 11

MC

Cleaning Door EF 4

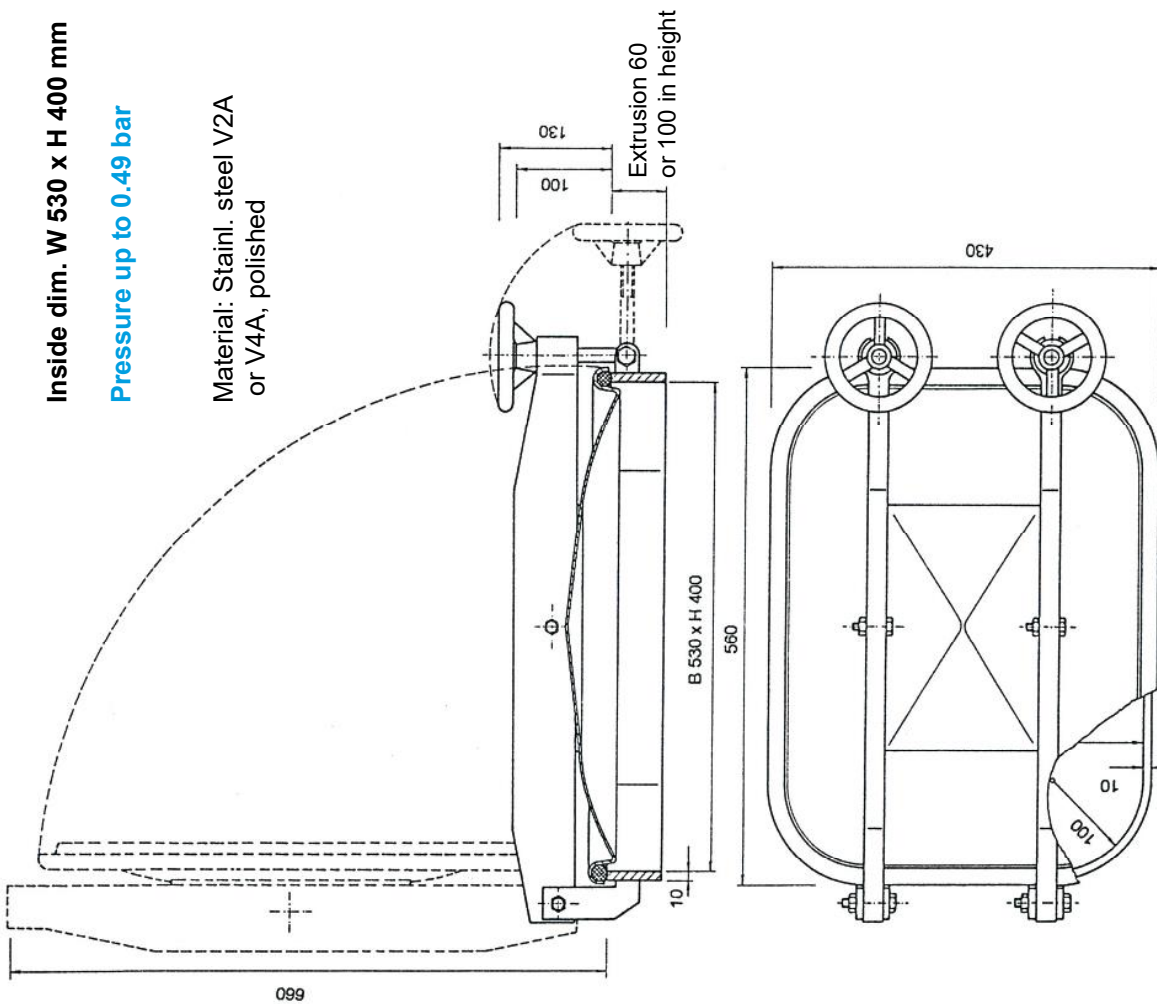

Illu. 12

Cleaning Door E 4, upright

MC

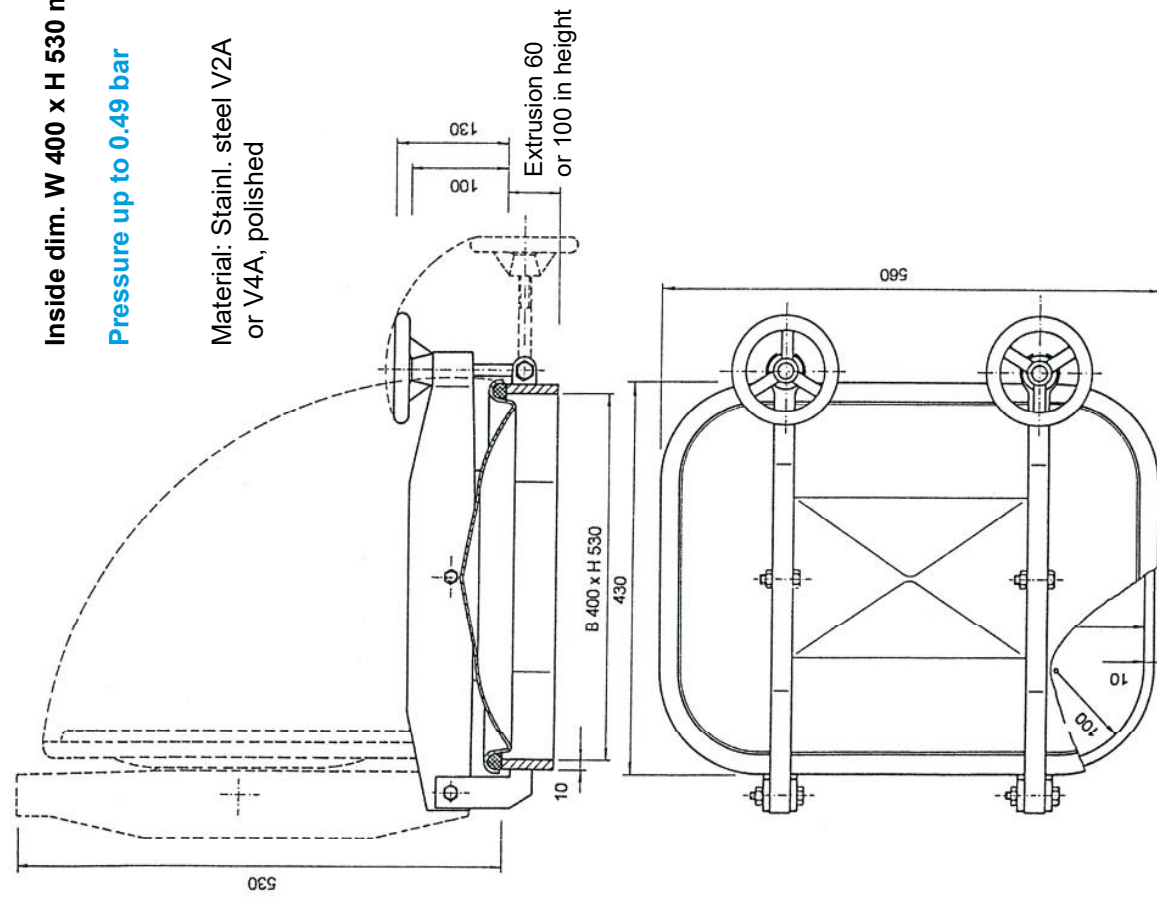

Illu. 13

Type M-G

Pressure -1 / +3 bar

Dome cover made from stainless steel 1.4301 or 1.4401 with glass plate
 Fastening screws may be swivelled to the side,
 Plastic star handle with hinge and handle to swing cover open
 Polished surface, other surface finishes available on request
 Standard design comes with silicon seal

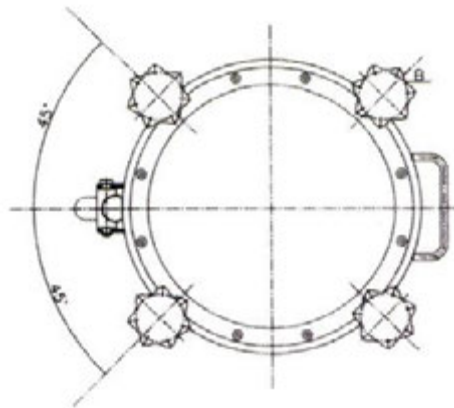
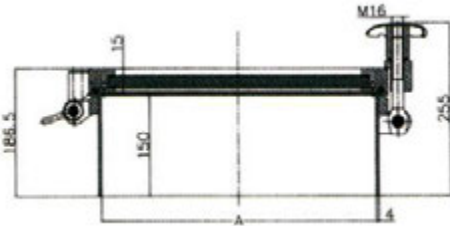

Shroud height variable, on request!

Number of screws B	4	4	6	6
Ø in mm A	400	450	500	600
Max. pressure (bar)	-1 / +3	-1 / +3	-1 / +3	-1 / +3

Type M-GO

Pressure -1 / +3 bar

Dome cover made from stainless steel 1.4301 or 1.4401 with glass plate
Oval design
 Fastening screws may be swivelled to the side
 Plastic star handle with hinge and handle to swing cover open
 Polished surface, other surface finishes available on request
 Standard design comes with silicone seal

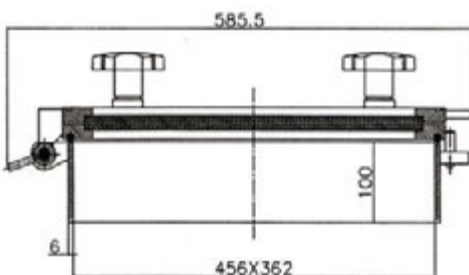

Shroud height variable, on request!

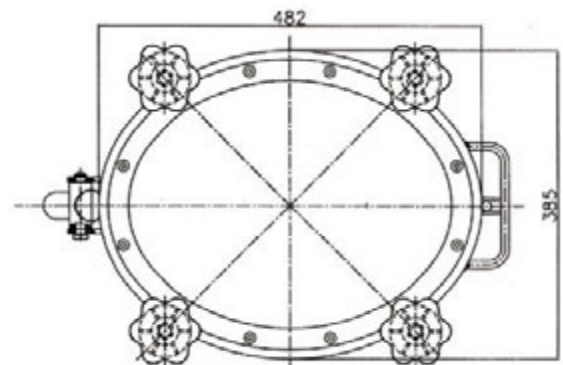

Type M-B

Pressure -1 / +1 bar

Dome cover made from stainless steel 1.4301 or 1.4401
 Fastening screws may be swivelled to the side,
 Plastic star handle with hinge and handle to swing cover open
 Polished surface, other surface finishes available on request
 Standard design comes with silicon seal

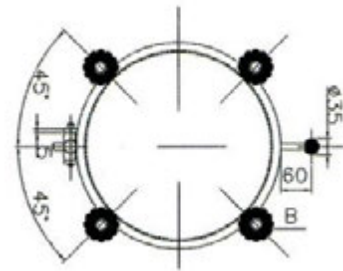
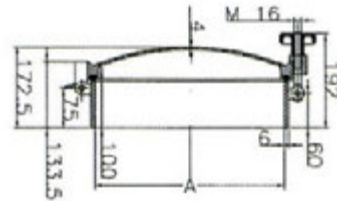

Shroud height variable, on request!

Type	Ø 200	Ø 250	Ø 300	Ø 400	Ø 450	Ø 500	Ø 600	Ø 700	Ø 800
Ø in mm A	203	250	300	410	460	510	610	700	800
Number of screws B	4	4	4	4	4	4	6	8	8

Type M-D1

Pressure -1 to +6 bar (see table)

Fastening screws may be swivelled to the side,
 Plastic star handle with hinge and handle to swing cover open
 Polished surface, other surface finishes available on request
 Standard design comes with silicon seal

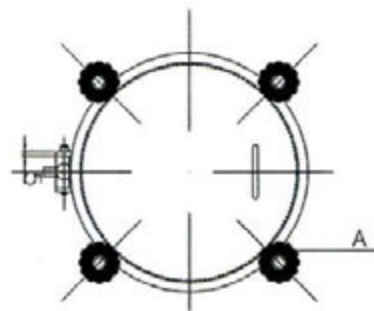
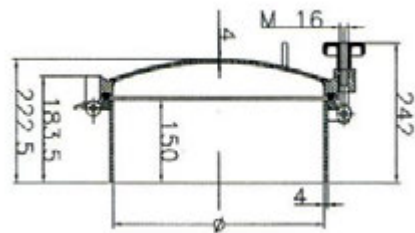

Porthole is an accessory!

Shroud height variable, on request!

Number of screws B	4	6	4	6	6	8	6	8	6	8
Ø in mm A	300	300	400	400	450	450	500	500	600	600
Max. pressure (bar)	-1 / +4	-1 / +6	-1 / +4	-1 / +6	-1 / +4	-1 / +6	-1 / +3	-1 / +6	-1 / +2	-1 / +4

Dome Cover Type M-D2

MC

Type M-D2

Pressure -1 up to +10 bar (see table)
 Fastening screws may be swivelled to the side,
 Stainless steel star handle
 with hinge and handle to swing cover open
 Polished surface, other surface finishes available on request
 Standard design comes with silicon seal

Number of screws B		A Ø 300 • 400 • temperature					C
		50 C°	100 C°	150 C°	200 C°	250 C°	
Ø 300	Ø 400	max. pressure in bar					
4	4	3.5	3.0	3.0	2.5	2.0	4
6	6	5.0	4.5	4.5	1.0	3.0	4
8	8	6.5	6.0	6.0	5.5	4.0	4
	10	8.5	7.5	7.5	7.0	5.0	5
	12	10	9.0	8.5	8.0	6.5	5

Number of screws B	A Ø 450 • temperature					C
	50 C°	100 C°	150 C°	200 C°	250 C°	
max. pressure in bar						
4	2.5	2.5	2.0	2.0	2.0	4
6	4.0	3.5	3.5	3.5	3.0	4
8	5.5	5.0	4.5	4.5	4.0	4
10	6.5	6.0	6.0	5.5	5.0	4
12	8	7.5	7.0	6.5	6.0	5

Number of screws B	A Ø 500 • temperature					C
	50 C°	100 C°	150 C°	200 C°	250 C°	
max. pressure in bar						
4	2.0	2.0	2.0	1.5	1.5	4
6	3.5	3.0	3.0	2.5	2.5	4
8	4.5	4.0	4.0	3.5	3.5	4
10	5.5	5.0	4.5	4.5	4.0	4
12	8.5	6.0	5.5	5.5	5.0	4
14	7.5	7.0	6.5	6.0	6.0	5

Number of screws B	A Ø 600 • temperature					C
	50 C°	100 C°	150 C°	200 C°	250 C°	
max. pressure in bar						
6	2.0	2.0	2.0	2.0	1.5	4
8	3.0	3.0	2.5	2.5	2.5	4
10	4.0	3.5	3.5	3.0	3.0	4
12	4.5	4.0	4.0	4.0	3.5	4
14	5.5	5.0	4.5	4.5	4.0	4

Number of screws B	A Ø 700 • temperature					C
	50 C°	100 C°	150 C°	200 C°	250 C°	
max. pressure in bar						
6	1.0	1.0	1.0	0.5	0.5	4
8	1.5	1.5	1.5	1.5	1.5	4
10	2.5	2.5	2.0	2.0	2.0	4
12	3.5	3.0	3.0	3.0	3.0	4
14	4.0	3.5	3.5	3.5	3.5	4



Porthole is an accessory!

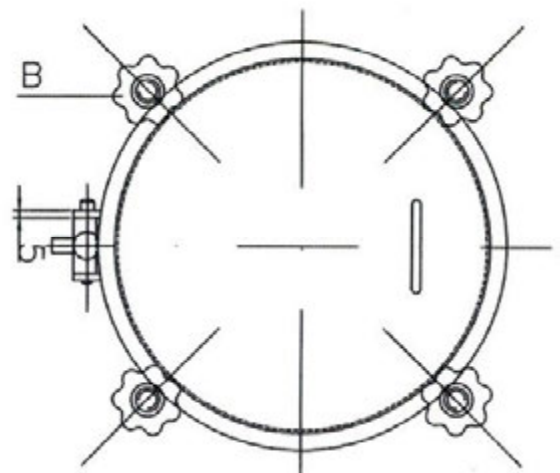
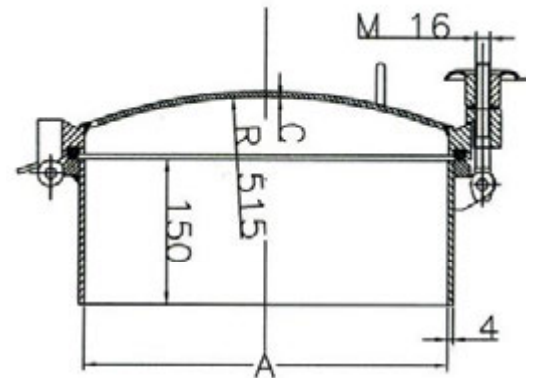

Terms of Payment and Delivery

1. If not stated differently, sale and shipment are effected according to the prices and price listings valid on the day of delivery, respectively date of readiness for dispatch.

Prices quoted are subject to VAT when shipped within the Federal Republic of Germany.

2. All delivery times quoted correspond to the day of shipping. They are without obligations unless specified differently.

Operational disturbances through no fault of our own (strikes, force majeure, etc.) relieve us from our obligation to supply for as long as these factors continue to interfere with our operating procedures.

All shipments are effected at the customer's own expense and risk. We reserve the right to choose the means of transportation if not specifically advised otherwise by the customer in writing. We reserve the right for partial deliveries, in agreement with the buyer. Partial deliveries are to be paid for immediately.

3. Accounts are to be settled within 30 days in full after billing date, unless specified otherwise and confirmed by MC. We offer a 2% discount on the value of goods if we receive your payment within 10 days after billing date. Invoice values of under 41.00 EURO are subject to an extra charge of 15.00 EURO for small quantities and can not be granted a cash discount as specified above.

MC reserves the right to enforce interest on late payments and dunning charges when not complying with the terms of payment and payment deadlines. Rates of interest correspond to the bank rates valid at the date of service.

4. Packaging is calculated at cost price and may not be returned.

5. All information and data in MC's catalog and worksheets is without obligation.

We ask you to request detailed confirmations from us if specific requirements necessitate guarantees for dimensions, operational conditions or production matters.

6. Claims are to be effected immediately upon receipt of the consignment. Otherwise, the goods are accepted as free of defects.

Defective goods are replaced upon return when shipped by MC or credited at MC's discretion.

Incomplete delivery quantities are only acknowledged when their packaging is defective. Defects are subject to the shipping company's confirmation.

The buyer is not authorized to assert any damage claims or rights beyond that to MC, irrespective of their cause in law.

7. Implied warranties apply for proper handling, with the exception of all wear parts, including nozzles, seals, mechanical seals, etc..

8. MC reserves all proprietary rights for the goods delivered until complete payment of purchase price. If the buyer should sell the goods delivered by MC before payment is complete, all claims resulting from the sale are assigned to MC.

9. Place of payment and delivery is Ostfildern, Germany.

Place of jurisdiction is Stuttgart, Germany.